



RUBIQTM

I N T E R N A T I O N A L

"Crafting Excellence, Covering Dreams!"

RUBIQ INTERNATIONAL

🌐 www.rubiqinternational.com
✉ rubiqinternational@gmail.com
☎ +91 88 66 42 42 44

"Build Your Work & Living Space – Strong, Smart,
and Sustainable!"

About Our Company

A Brief About The Company

We are a leading fabrication company specializing in roofing fabrication, modern portable homes, gazebos, pre-engineered buildings (PEB) sheds, industrial structures, and customized metalworks. With a strong commitment to quality, innovation, and durability, we deliver top-notch fabrication and structural solutions tailored to meet residential, commercial, and industrial needs.

Our expertise lies in precision engineering, high-grade materials, and cutting-edge technology, ensuring structures that are strong, weather-resistant, and cost-effective. Whether it's a sleek and modern portable home, an elegant gazebo for outdoor spaces, a durable industrial shed, or a custom metal structure, we turn ideas into reality with superior craftsmanship.

We also offer end-to-end project solutions, including design, fabrication, installation, and maintenance, ensuring seamless execution and long-lasting performance. Our goal is to provide sustainable, innovative, and efficient fabrication solutions that enhance both functionality and aesthetics.

Partner with us for reliable, high-quality, and customized fabrication services designed to exceed expectations!

Precision Crafted, Designed
for Comfort – Built to Last!



Sanjay Gondaliya

Founder

Vision

Our vision is to be a pioneering force in the fabrication industry, setting new benchmarks in quality, innovation, and sustainability. We strive to create strong, aesthetically appealing, and cost-effective structures that enhance modern living and industrial efficiency.

Mission

We strive to fulfill all the requirements of clients as well as architects without affecting structure's quality, durability and stability.

Continuously adopting cutting-edge fabrication techniques to create modern, efficient, and sustainable structures.

Offering comprehensive services, from design and fabrication to installation and maintenance, ensuring seamless project execution.

Ethics

- **Uncompromising Safety** – Prioritizing the highest safety standards in every project to protect our team, clients, and structures.
 - **Embracing Modern Technology** – Continuously integrating advanced techniques and innovations to enhance efficiency and quality.
 - **Strong Commitment** – Staying dedicated to delivering excellence, reliability, and customer satisfaction in every aspect of our work.
 - **Building Professional Relationships** – Fostering trust, transparency, and long-term collaborations with clients, partners, and Architect.
-

Modern House



Experience the future of housing with our innovative, eco-friendly fabricated homes—built without cement or steel! Using advanced dry construction materials like engineered wood, prefabricated panels, and lightweight composites, we create homes that are:

- ✓ **Fast to Build** – Up to 50% quicker than traditional construction.
- ✓ **Eco-Friendly** – Uses sustainable materials with minimal waste.
- ✓ **Energy Efficient** – Designed for better insulation & lower energy costs.
- ✓ **Customizable & Durable** – Modern designs with modular flexibility.

Upgrade to a smarter,
greener, and stronger living
space today!

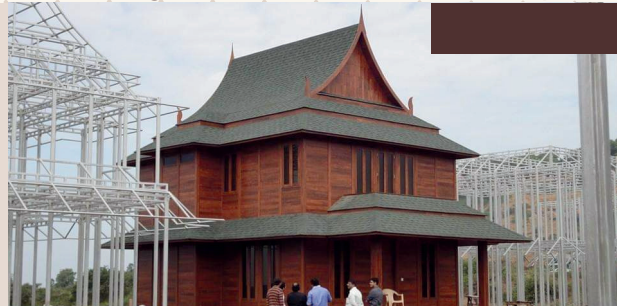

"Step into a future of smarter,
greener, and stronger living!"

Modern House

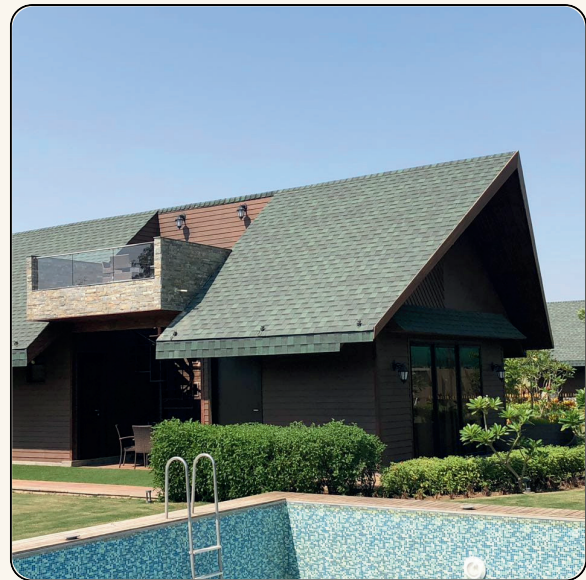

Office



Gazebo



Enhance your outdoor space with a modern gazebo, designed for style, comfort, and durability.

- ✓ **Sleek & Minimalist Design** – Perfect for contemporary outdoor spaces.
- ✓ **Weather-Resistant & Durable** – Built with high-quality, long-lasting materials.
- ✓ **Customizable & Versatile** – Ideal for relaxation, gatherings, or a stylish outdoor space
- ✓ **Eco-Friendly & Sustainable** – Constructed using non-toxic, recyclable materials.

"Upgrade your outdoor experience with us."



PEB Shed

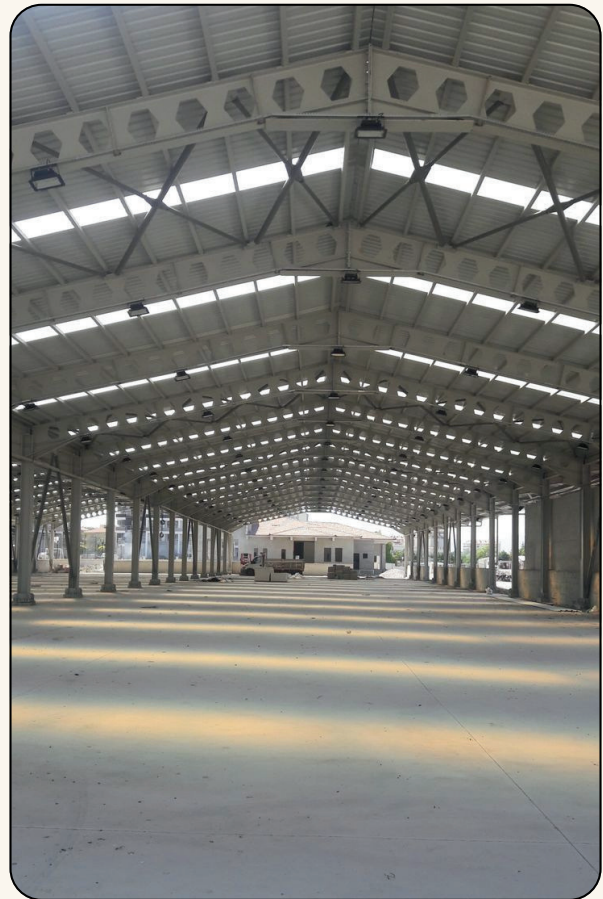

A Pre-Engineered Building (PEB) Shed is a modern, high-strength solution for industrial, commercial, and storage applications. Designed for efficiency, durability, and quick installation, PEB sheds are fabricated using high-quality steel components, ensuring cost-effectiveness and structural stability.

- ✓ **Fast & Efficient Construction** – Prefabricated components reduce on-site work and installation time.
- ✓ **High Strength & Durability** – Engineered for extreme weather conditions and heavy loads.
- ✓ **Cost-Effective & Low Maintenance** – Optimized material usage for long-term savings.
- ✓ **Customizable Designs** – Tailored for warehouses, factories, workshops, and commercial spaces.



- Perfect choice for businesses looking for an efficient, strong, and long-lasting building solution

PEB Shed





"Seamless Design, Ultimate Strength – Redefining Spaces with Tensile Fabric!"

Tensile Work





"Innovative Shade, Unmatched Strength!"

Tensile Work

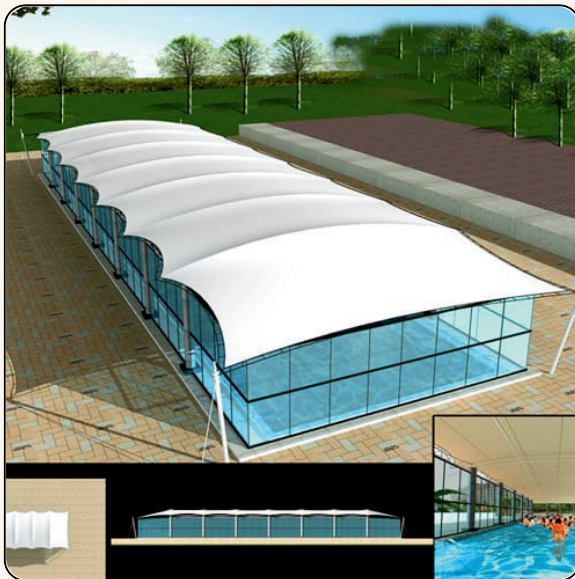

- Perfect for rooftops, parking, stadiums, resorts, or garden spaces, a tensile roof enhances both functionality and style.
- Made from high-performance tensile fabric, it offers superior protection, flexibility, and style for various applications.

Sport Turf/Court

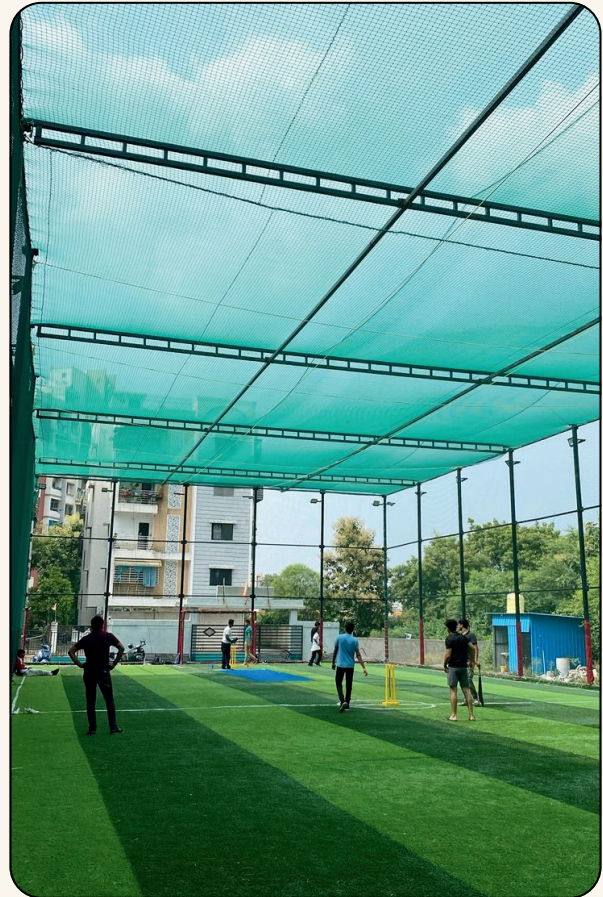

Sport Turf/Court



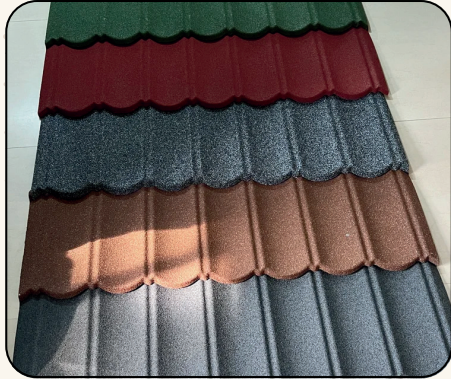

METAL ROOF TILES



Stone-coated metal roof tiles combine the durability of metal roofing with the classic beauty of traditional tiles, offering a long-lasting, weather-resistant, and stylish roofing solution. Made from high-quality galvanized steel and coated with natural stone chips, these tiles provide superior protection, energy efficiency, and aesthetic appeal.



- **Noise Reduction** – Stone coating minimizes noise from rain and hail, ensuring a quieter home.
- **Energy Efficient** – Reflects heat, keeping interiors cooler and reducing energy costs.
- **Lightweight & Easy to Install** – Strong yet lightweight, reducing structural load.



Roofing Shingles

Roofing shingles are a premium roofing material known for their aesthetic appeal, durability, and excellent weather protection. Available in a variety of textures, colors, and styles, shingles enhance the beauty and strength of any residential, commercial, or resort-style structure.

- **Aesthetic & Versatile** – Wide range of colors, textures, and finishes to complement any architectural style.
- **Fire & Impact Resistant** – Built with high-quality, fire-resistant materials for added safety.
- **Durable & Long-Lasting** – Designed to withstand extreme weather conditions, including heavy rains, wind, and UV exposure.

Ideal for residential homes, villas, resorts, and commercial buildings, roofing shingles provide a modern, elegant, and highly durable roofing solution.

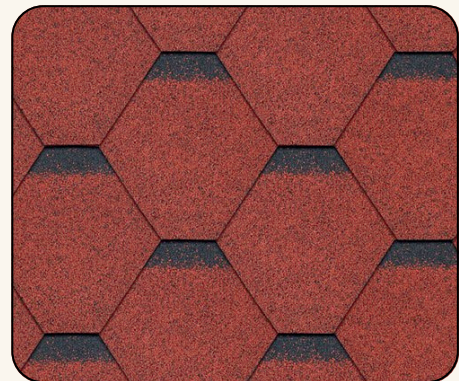

FRP Swimming Pool



FRP (Fiber-Reinforced Plastic) swimming pools are a modern alternative to traditional concrete pools, offering durability, quick installation, and low maintenance. These pools are designed with high-quality composite materials, making them lightweight, leak-proof, and long-lasting.

✓ Key Benefits:

- **Quick & Easy Installation** – Pre-molded structures allow for faster setup compared to concrete pools.
- **Durable & Crack-Resistant** – FRP pools are highly resistant to cracks, leaks, and wear.
- **Low Maintenance** – Smooth, non-porous surfaces prevent algae growth and reduce cleaning efforts.
- **UV & Chemical Resistant** – Withstands sunlight exposure and pool chemicals without fading or damage.
- **Cost-Effective** – Lower installation and maintenance costs compared to traditional pools.
- **Co-Friendly** – Uses less water and chemicals due to better water retention properties.

Signature Projects

Vintage Village House – A Timeless Symbol of Saurashtra's Heritage

One of our signature projects, this remarkable village house was meticulously crafted for a renowned company in Gujarat. Designed to reflect the authentic charm of an old vintage home, it beautifully captures the essence of Saurashtra's traditional architecture.

Built using natural and locally sourced materials such as stone, clay, and bamboo, the structure embodies the age-old craftsmanship of rural Gujarat. The walls and flooring are coated with the traditional cow dung method, a practice deeply rooted in Indian culture, known for its antibacterial properties and natural insulation.

This project is not just a house—it is a living tribute to Gujarat's rich rural heritage, where every element tells a story of simplicity, sustainability, and timeless tradition.



Het Ni Haveli, Dudhala, Amreli
(Hari Krishna Exports Pvt. Ltd.)

Resort Development



Project Executed For

- Raghuveer Builder & Developers, Surat.
- D. H. Patel & Co., Surat.
- Dharmanandan Diamond (DD), Surat.
- Kiran Diamond, Surat.
- Paladiya Brothers, Surat.
- Desai & Jain Group Surat.
- Game Park, Mumbai.
- Sotec Pharma Pvt. Ltd., Sanand
- KKB Infra, Surat.
- The Heaven Water Park, Kagvad, Rajkot.
- King Water Park, Virpur, Rajkot.
- The Enjoy City Water Park, Vadodara.
- Surat Municipal Corporation, Surat.
- L. P. Savani School, Surat.
- Paramount International School, Surat.
- La-casa Club & Resort, Palsana.
- Rio Colina Club & Villa, Kamrej.
- Clok Tower, Sharmishtha Lake, Vadnagar.
- Minksi Diamond, Surat.
- Bhagvati Diamond, Surat.
- Prayosha Group, Surat.
- De-villa Garden Restaurant, Surat.
- The Gold Beach Resort, Daman.
- Duke Hotel, Daman.
- Lakeview Hotel, Saputara.
- White Feather Resort, Kauncha Silvassa.
- Anjani Diamond, Surat.
- Shapoorji Pollanji Park West Project, Bangalore.
- Bhakti Infra, Panoli.
- Shivdhara Resort, Ahmedabad.
- Mangonese Villa, Navsari.
- VASV Venture LLP, Bengaluru.
- Majaza Alibag, Maharastra.
- Samart Sports, Mumbai.
- Deltin, Alibag.
- Mariott Suites, Pune.
- Tyro Turf, Ahmedabad.
- Sporbit Gurugram.
- P. P. Savani Group, Surat.
- Nitesh Nappa valley Project, Bangalore.
- L.P.S. Infra, Surat.
- Tru Blu Nappa Valley Project, Bangalore.
- Mantri Manyata Lithos Project, Bangalore.

We Are Available At

Contact us At :

rubiqinternational@gmail.com

+91 88 66 42 42 44

Branch Office:

503 Magnet Square, Near
Home Town 3, New Ranip,
Ahmedabad, Gujarat
382480

Head Office:

223, Soham Arcade,
Opp Bagban Circle,
Adajan, Surat, Gujarat.

Branch Office:

Office No. 368/B Buticas,
Navelim, Salcete
South Goa - 403707